

MONBAT Formula A99B5P0_1 95 Ah

According to EN 50342



Formula

SEALED MAINTENANCE FREE



Electrical specification

Voltage:	12V
Capacity C²⁰:	95 Ah
Cold cranking current:	800 A [EN]
Cold cranking current:	490 A [DIN]

Mechanical specification

Dimensional group:	LB5
ETN reference:	595 021 080 SMF
DIN reference:	59521
Dimensions^A in mm (LxWxH)	353x175x175
Cell Layout:	0
Terminal Type:	1

Container

Case	Material	Polypropylene
	Bottom hold-down	B4
	Colour	Black

Lid	Material	Polypropylene
	Cover design	SMF
	Colour	Black

Vent caps	Material	Polypropylene
	Type	SMF
	Colour	Black

Handles	Material	Polypropylene
	Position	Top - on lid
	Colour	Black

Battery classification as per EN 50342-6

Water consumption	Charge retention	Vibration resistance	Endurance Level
W4	C2	V1	E1

Weight^B

Battery weight in kg:	14.45
Acid weight in kg:	6.80
Total battery weight in kg:	21.25

Layout

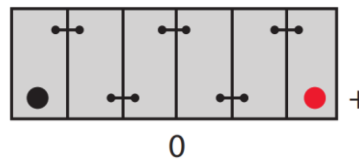

Hold-down

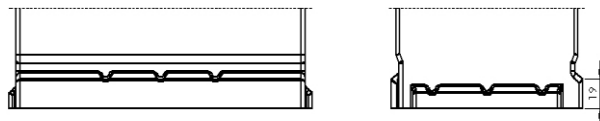

Separator

Type	PE
-------------	-----------

A. Height taken from bottom of the battery to the highest point on the battery. Heights may vary depending on type of terminal.
B. Weight may vary ±5%.